

Crown Street Southwark, London

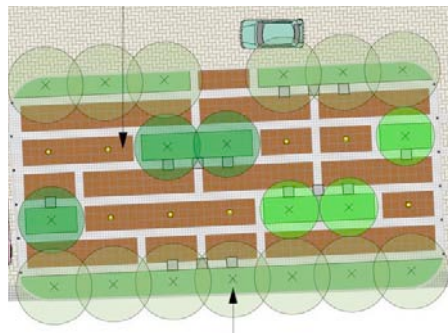

We were appointed by our client to develop a planning approved scheme and to provide them with information to discharge all landscape related conditions for this proposed mixed use/ residential development which is composed of five distinct blocks.

As the site is adjacent to a railway viaduct with arches which are occupied by local business our proposals needed to provide them with vehicular access whilst giving the site the feel of a pedestrian focused space. The carriageways and footways within our proposals are generally designed as shared type spaces, providing an appropriate setting for this type of development.



At the heart of this development is a public open space. The space has been designed in such a way so as to be permeable to pedestrians along its north, south and east edges. The planting within this space will help to provide enclosure and has been used to create a number of spaces where residents and friends can meet.



Client
Parritt Leng

Architect
Parritt Leng

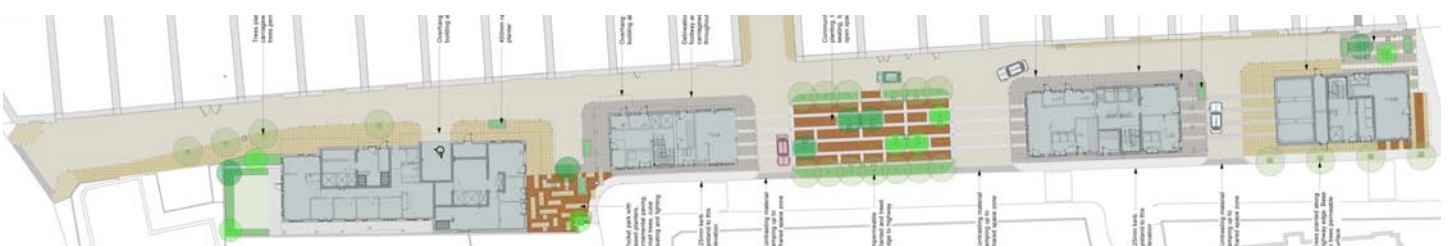

15 Iliffe Yard | London | SE17 3QA | 020 7277 1035 | mail@davisla.com | www.davisla.com