

# 219-221 Bow Road

## Bow, London



We were appointed by our client to produce drawings and a landscape design statement. These were to be submitted to the Planners as part of a detailed planning application for this proposed residential development.

This site is adjacent to a residential scheme for which we were also the landscape architects, also with the same developer. The issues were similar in that this is a deep plot with a narrow frontage onto Bow Road. In addition part of our brief was to seamlessly stitch our proposals with those of the adjacent plot, creating a single unified public realm. In addition the design team needed to consider at the planning stage how this phase would be built with the adjacent development already being occupied.



We considered the entire space within this residential scheme to have pedestrian priority, with necessary occasional vehicular access. It was designed as a shared space with no kerbs defining footway and carriageway. The bands of paving of the adjacent residential scheme were continued through into this one.

Two toddlers play areas were integrated into our proposed public amenity spaces, maximising the potential uses of this valuable external space.

Cycle storage, refuse storage, two disabled parking spaces, fire tender access and refuse vehicle access were all accommodated within our proposals.

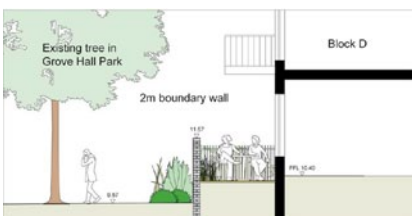

Section AA  
1:100 @ A3



Plan  
Scale 1:100



Section BB  
1:100 @ A3

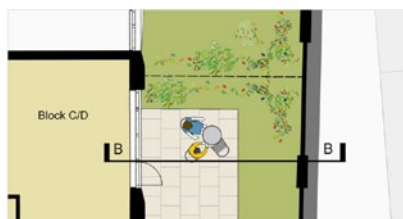

Plan  
Scale 1:100



15 Iliffe Yard | London | SE17 3QA | 020 7277 1035 | mail@davisla.com | www.davisla.com

**Client**  
Aitch Group

**Architect**  
StockWool