

Wapping High Street Wapping, London

We were appointed by our client as landscape architects for this residential development located on the north bank of the River Thames, London. Our scope of works was to prepare information to discharge landscape related conditions and the preparation of a full tender pack of information. The existing building is being converted for residential use and extended upwards. Our remit was to design a roof garden which is to be accessed by its residents.

Our proposals needed to consider the exposed environment in this location, seven floors up and on the banks of the River Thames. In addition we needed to be mindful of loading being imposed on the structural slab by our proposals. We needed to create an environment which residents would want to visit and enjoy the stunning views which are on offer.

Access requirements to this roof space were also carefully considered as was the screening of necessary roof top plant and solar panels.

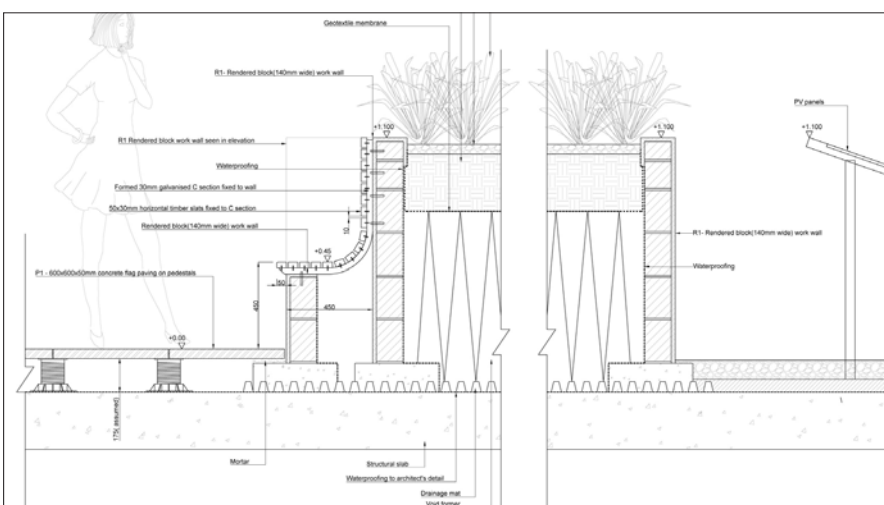
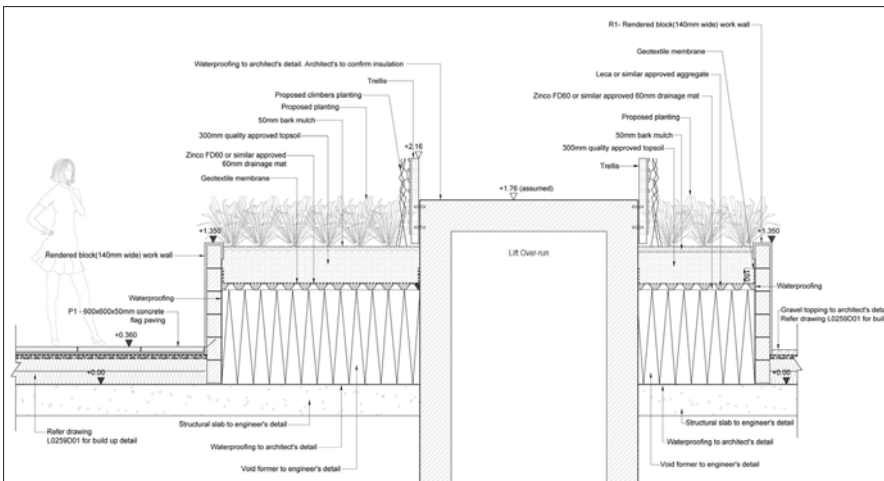

Client
O'Shea

Architect
Galliard Homes

15 Iliffe Yard | London | SE17 3QA | 020 7277 1035 | mail@davisla.com | www.davisla.com