

Rowan House DA Colindale, Barnet, London

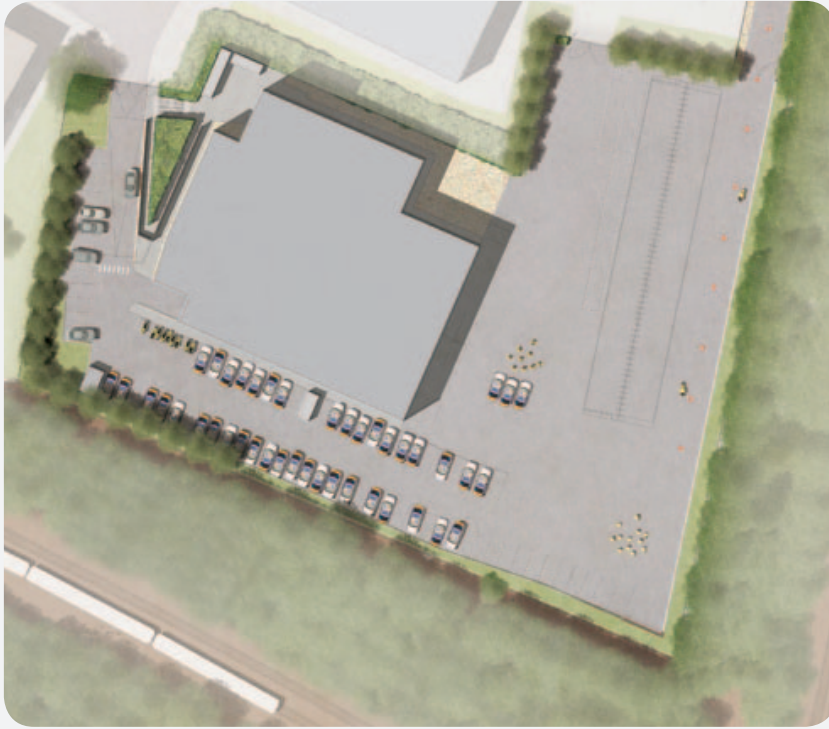

We were appointed by a contractor client as landscape architects on this 2.08ha brownfield site that houses a dedicated training facility for the Metropolitan Police Driving School. Our scope was to provide information to satisfy landscape related Conditions, provide full tender and construction packages of landscape information and to monitor the on site works.

The plot is irregular in shape with one long edge to the east boundary. Outside the south and east boundaries are the Northern Line Underground and a Network Rail railway lines. Between these lines and the plot boundary is a significant belt of existing trees, all of which were to be retained. There is an existing fall of approximately 4.5m for the west to the east boundary.

The proposed external works to this development included an appropriate pedestrian entrance zone for the building, staff car parking, a wobble road for motorcycle training, a C1/ D1 training area, a secure line to the perimeter of the site and structural landscape planting.

Due to the significant east/ west cross fall, ground levels were considered very carefully from the outset of this project. This helped to minimise the volume of fill that was to be exported from site. The need for retaining structures also formed part of this exercise, along with the need for Part M compliant pedestrian access routes.

Existing trees that were to be retained were also considered carefully from an early stage of design process. Their continued healthy growth was considered an important constraint to the Local Authority.



Client
Metropolitan Police

Contractor
Mace Construction

Architect
Bryden Wood Architects

15 Iliffe Yard | London | SE17 3QA | 020 7277 1035 | mail@davisla.com | www.davisla.com

Davis Landscape Architecture Limited
Registered in England and Wales
Company Number 07018870
VAT Registration Number 979558439

**Landscape
Institute**
Registered practice

Davis
Landscape Architecture