

## Pranabanti Karmakar - Curriculum Vitae

Landscape Architect - MScLA, BA (Hons)



### Professional Experience

2019 - Present - Landscape Architect - Davis Landscape Architecture, London  
2018 (Summer) - Intern Landscape Architect - Urban Wilderness, Leeds  
2015 - 2017 - Assistant Landscape Architect - Hiland Group, Kolkata, India  
2012 - 2015 - Assistant Architect - La Vista, Delhi, India

### Education

2017 – 2019 - Landscape Architecture Masters - The University of Sheffield, UK  
2007 – 2012 - BA Architecture - Jadavpur University, India

### Key Projects

[Click to See More](#)

**Leyton Green Road, Walthamstow** Assisting in the preparation of information for a high quality landscape design for a new build housing development for a local authority, located on a 0.4ha brownfield plot. Proposals included a variety of amenity spaces with play, planting, private patios and a SUDS strategy with high expectations. Numerous existing trees within the plot boundary were to be retained.  
**On Site:** 2020  
**Scope:** Planning, Tender, Construction  
**Architect:** Fraser Brown McKenna  
**Client:** LB of Waltham Forrest  
Jerram Falkus



**High Street, Sutton** Assisting in the preparation of a landscape design statement for this residential development located over commercial units. Our proposals were to support a detailed planning submissions following consultee comments. Our scope was the design of ground level car parking with planting over a podium deck and a communal roof top amenity space.  
**Complete:** 2020  
**Scope:** Planning  
**Architect:** Harp & Harp  
**Client:** Mizen Design Build



**Southampton Way, Southwark** Assisting in the preparation of a landscape strategy for a proposed residential development and an area of land to be gifted to the Local Authority. The area of land sits at the edge of an area of Metropolitan Open Land and is to be incorporated into this designation. The area to be gifted was designed as a continuation of an existing wildlife area/ nature trail.  
**Complete:** 2020  
**Scope:** Pre Application  
**Architect:** Alan Camp Architects  
**Client:** Burlington Developments



**Broadfield Primary School, Crawley** Assisting in the preparation of a school landscape design statement to support a detailed planning submissions for a 0.16ha brownfield plot. The entire school external play area is located on a podium deck to a lower ground floor car parking area. The landscape strategy to the carriageway edge of the plot was important to the local authority and a significant green edge was specified.  
**Complete:** 2020  
**Scope:** Planning  
**Architect:** Blackstone Architects  
**Client:** Crawley Mosque

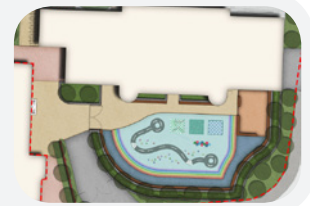

**South Street, Romford** Assisting in the preparation of a residential landscape design statement to support a detailed planning submissions for a 0.3ha brownfield plot. Proposals included a podium deck amenity space with play and private patios. An existing Play Assessment report and an Urban Greening Factor calculation were also required as part of this submission.  
**Complete:** 2019  
**Scope:** Concept, Planning  
**Architect:** Dunnett Craven  
**Client:** Caerus Developments



15 Iliffe Yard | London | SE17 3QA | 020 7277 1035 | [mail@davisla.com](mailto:mail@davisla.com) | [www.davisla.com](http://www.davisla.com)

Davis Landscape Architecture Limited  
Registered in England and Wales  
Company Number 07018870  
VAT Registration Number 979558439

**Landscape  
Institute**  
Registered practice

**Davis**  
Landscape Architecture

## Key Projects

[Click to See More](#)

**Leatherhead Road, Chessington**  
**Complete:** 2019  
**Scope:** Concept, Planning  
**Architect:** Clive Sall Architects  
**Client:** Ross Sloan Investments

Assisting in the preparation of a residential landscape design statement to support a detailed planning submissions for a 0.65ha plot located on the footprint of eight existing dwellings. Proposals included parking, shared surfaces and a communal flooding "green" which integrates play. Constraints included challenging levels and existing trees to the plot perimeter.



**Coral, Romford**  
**Complete:** 2019  
**Scope:** Concept, Planning  
**Architect:** BUJ Architects  
**Client:** Passion Property Group

Assisting in the preparation of a residential landscape design statement to support a detailed planning submissions for a 0.41ha brownfield plot. Proposals included four podium deck amenity spaces; each with play and ground level parking. An existing Play Assessment report and an Urban Greening Factor calculation were also required as part of this submission.



**Westmead Road, Carshalton**  
**Complete:** 2019  
**Scope:** Concept, Planning  
**Architect:** Caerus Developments  
**Client:** Caerus Developments

Assisting in the preparation of a residential landscape design statement to support a detailed planning submissions for a 0.19ha brownfield plot. Proposals included three amenity spaces with play integrated into each. An existing Play Assessment report and an Urban Greening Factor calculation were also required as part of this planning submission.



**New Kent Road, Southwark**  
**Complete:** 2019  
**Scope:** Concept, Planning  
**Architect:** Clive Sall Architects  
**Client:** Eden Vale Global

The preparation of two landscape strategies for two planning submissions; one option for work space/residential and one for hotel. The site is located a 0.15ha brownfield plot next to a busy London Red Route. Both proposals aimed to green the entire building; with a series of gardens located on the various levels providing a variety of intimate spaces.



**Beech Avenue, Croydon**  
**Complete:** 2019  
**Scope:** Concept, Planning  
**Architect:** Fairbairn : MHK  
**Client:** Confidential

Assisting in the preparation of a residential landscape design statement to support a detailed planning submissions for a 0.46ha greenfield/ brownfield plot. Proposals included disabled parking, pedestrian circulation and a communal garden space which integrated play. Constraints included challenging levels across the site and existing TPO trees.



**Gillan Court, Lewisham**  
**Complete:** 2019  
**Scope:** Concept, Planning  
**Architect:** JM Architects  
**Client:** Riverside Housing

Assisting in the preparation of landscape architect's information to support a Detailed Planning submission for this 0.27ha brownfield site with a retained residential block. The landscape proposals consisted of a shared play space, car parking private gardens and shared circulation routes. Constraints included existing TPO trees and Party Walls.



**Queens Walk, Brent**  
**Complete:** 2019  
**Scope:** Concept, Planning  
**Architect:** Saloria Architect  
**Client:** Private

Assisting in the preparation of landscape architect's information to support a Detailed Planning submission for proposed dwellings located on a 900msq brownfield plot. The landscape proposals consisted of a shared play space, car parking private gardens and circulation routes. Constraints included existing trees and a significant change in level across the site.



15 Iliffe Yard | London | SE17 3QA | 020 7277 1035 | [mail@davisla.com](mailto:mail@davisla.com) | [www.davisla.com](http://www.davisla.com)

Davis Landscape Architecture Limited  
Registered in England and Wales  
Company Number 07018870  
VAT Registration Number 979558439

**Landscape  
Institute**  
Registered practice

**Davis**  
Landscape Architecture